

# ITD. SUCCESS IS DEFINED LIKE THIS

Welcome



Since 1995, ITD GmbH has stood for Innovation, Technology and Design in the area of stationary and mobile carrier systems for medical technology. The goal has been to develop, produce and market products that belong to the world's best. We ensure that high-quality electromedical equipment finds optimum use. As specialist for custom stationary and mobile equipment carriers, the focus is on the market for medical technology products.

## **Quality you can touch for a lasting cooperation**

Product quality and customer satisfaction are of paramount importance to ITD GmbH. In order to fulfil these high quality expectations, ITD GmbH is committed to the most modern technologies and to well-trained, quality-conscious employees.

The combination of knowing the fields of application for the products, market-oriented development and above all the close partnership with the customer - from idea to finished product - a quality product is created to meet individual requirements. Today as well as in future.

# CONTENT

Product attributes and applications .....	4
The product configurator (online) .....	6
Overview of product portfolio .....	8



## uni-cart 10

Application examples <b>uni-cart</b> ..	12
Order configurations <b>uni-cart</b> .....	18
System components <b>uni-cart</b> .....	20



## vexio-cart 30

Application examples <b>vexio-cart</b> .....	32
Order configurations <b>vexio-cart</b> .....	38
System components <b>vexio-cart</b> .....	40



## pro-cart 52

Application examples <b>pro-cart</b> .....	54
Order configurations <b>pro-cart</b> ..	60
System components <b>pro-cart</b> .....	62



## classic-cart 72

Application examples <b>classic-cart</b> .....	74
Order configurations <b>classic-cart</b> .....	80
System components <b>classic-cart</b> .....	84

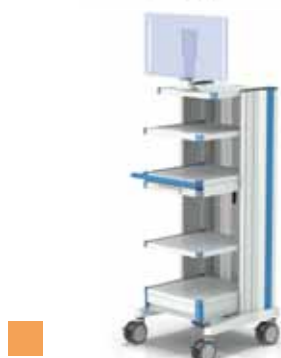

## compact-cart 96

Application examples <b>compact-cart</b> .....	98
Order configurations <b>compact-cart</b> .....	104
System components <b>compact-cart</b> .....	106



## ■ **Monitor carts** \_\_\_\_\_ 118

Order configurations ..... 120

## ■ **cart-couture** Customized product solutions \_\_\_\_\_ 124



## ■ **Accessories** \_\_\_\_\_ 128

Pivot arms <b>rm-port</b> .....	132
Variable height support arms <b>flexion-port</b> .....	133-135
Monitor crossbeam / Monitor shelf .....	136
Counterweight set .....	137
Baskets .....	138
Computer holder .....	139
Laptop holder .....	140
Power pack holder .....	140
Adapter plates for universal adapter .....	141
Endoscope holder .....	142
Drip glass .....	143
Connector holder .....	143
Rinsing bottle holder .....	144
Hose holder .....	144
Camera holder .....	144
(Gel)-bottle holder .....	145
Gas bottle holder .....	146
IV pole .....	147
Standard runner .....	147
Anchor / clamps .....	148
Rail fastener .....	148
Holder for suction system .....	149
Adapter pieces .....	149
Foot switch cradle .....	150
Jointed arms .....	150
Cable winders .....	151
Cable holder .....	151
Connection cable .....	152
EURO cable .....	153
Adapter cable .....	153
Equipotential plug POAG .....	154
Equipotential cable POAG .....	154
Socket strip attachment .....	155
Plug removal barrier .....	156
Spring nut .....	157
Equipment fixing corners .....	157

Item Number Index \_\_\_\_\_ 158

Keyword Index \_\_\_\_\_ 162

# OUR EXPERIENCE – YOUR SUCCESS

The objective of ITD is to react promptly to the latest market and environmental requirements. The aim is to allow our customers to exploit new opportunities for success. This is why we are dedicated to channelling our experience and our “craft assets” – innovative excellence, technical expertise and design competence into our products. ITD creates new benchmarks. Our products feature attributes like modularity, ergonomic design and quality. They are supported by service and customizing. This powerful combination generates product solutions that meet all the challenges of our sophisticated customers.

## Modularity – smart and individual

- The standard building-block system permits individual and cost-effective configurations.
- The modular support systems can be upgraded at any time. This permits prompt reactions to new demands in the marketplace and guarantees future-proof investments.
- The variability of height and / or width combine with an extensive range of generic accessories overarching all product lines to meet diverse needs and requirements.
- Easy planning is due to online product configurator everytime possible.



## Ergonomic design – adaptable and natural

- Smooth-running twin castors ensure simple manoeuvring of the equipment carts as well as the safe rolling over of obstacles.
- Adapted working areas and handle positions allow users to maintain a natural body position (sit / stand workstation).
- The support systems have been adapted to natural sequences of movement. The design of the base provides adequate leg room and permits freedom of movement.

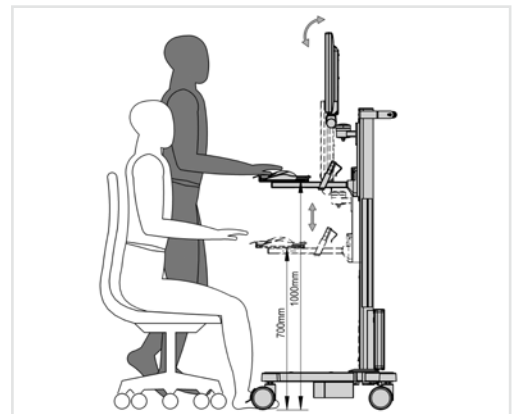

## Hygiene and Design – focused and modern

- The link between design and functionality focuses on instrumentation.
- The modern look and appealing, streamlined design underscore the high quality and value of the instruments.
- The absolute high standards of hygiene required in the everyday routine of hospitals and medical practices are reflected in the detail of the practical design.





## Quality – long service life and safe

- The use of high-quality materials, such as zinc-plated and powder-coated sheet steel or aluminium extrusions, guarantees the long service life and dependability of the product solutions.
- All support systems comply with the guideline 93 / 42 EWG as well as the standards according to DIN ISO 60601 (3<sup>rd</sup> Edition).
- Quality assurance is carried out strictly in conformity with DIN ISO 13485. Electrical safety is also tested and documented down to the last detail.



## Service – personal and efficient

- Professional technical personnel provide friendly and expert advice. Personal consultations are given on site or at our showrooms in Unterhaching, Johanniskirchen or in Naugatuch (CT, USA).
- Support is delivered throughout the project period by a dedicated personal contact.
- Expert foreign agents provide the foundation for the international presence of ITD.
- Detailed offers are prepared promptly.
- National and international logistics are supported comprehensively by e. g. ex-stock items and deliveries to end customers.



## Customizing – specific and characteristic

- Tailor-made customised solutions are based on an extensive standard programme enabling fast response to requirements at economical prices.
- Design of the equipment can be made in the colour of choice or with the corporate identity as required by the customer.
- On request, a package can be provided with customised corporate and product labelling, e.g. with the company logo or barcode.
- The design of the individual equipment carriers is carried out in cooperation with the ITD representative.

# THE ONLINE-PRODUCT CONFIGURATOR

The individual product solution in only 4 steps: with the user oriented Product Configurator, ITD GmbH provides the possibility of effortlessly learning about the comprehensive scope of products and configuring via Drag & Drop the different variants until an optimised personal solution has been found. In this way, not only can the various equipment trays be combined with the many components (single pictures) but these configurations can also be stored for later re-configuration or a non-binding inquiry with the click of a button.

**1** Select product series

**2** Define product options

**3** Active configuration via Drag & Drop

Optional with part list, dimensioning and change of representation

The screenshots illustrate the following steps:

- Select product series:** The user chooses a product series from a list of stationary cart systems and motor equipment carts.
- Define product options:** The user selects specific options for the chosen series, such as height, width, and motor type.
- Active configuration via Drag & Drop:** The user interacts with a 3D model of the cart, adding or removing components like shelves and drawers.
- Optional with part list, dimensioning and change of representation:** The final configuration is shown with detailed dimensions and a list of parts, allowing for a complete specification of the product.



## Your advantages at a glance:

- Arbitrary configurations of a simulation model can be created from all available standard components, including their descriptions.
- The components can be positioned clearly and uniquely via the Drag & Drop function, based on scales.
- With a click, the view can be changed between ISO-views, that is, between 3D- and 2D views (with the optional display of measurements).
- Plausibility checks, notes, aids, and a pleasing graphical display render the Product Configurator user-friendly and almost self-explanatory.
- The Configurator can be accessed online at any time of day and is always kept up-to-date.
- Configurations which have been stored can be reconfigured via automatically created access codes and can be stored as PDF files. Inquiries can be submitted with the click of a button.
- Switching between the configuration view and the item list requires no more than a mouse click.

Storage and inquiry

↓ 4

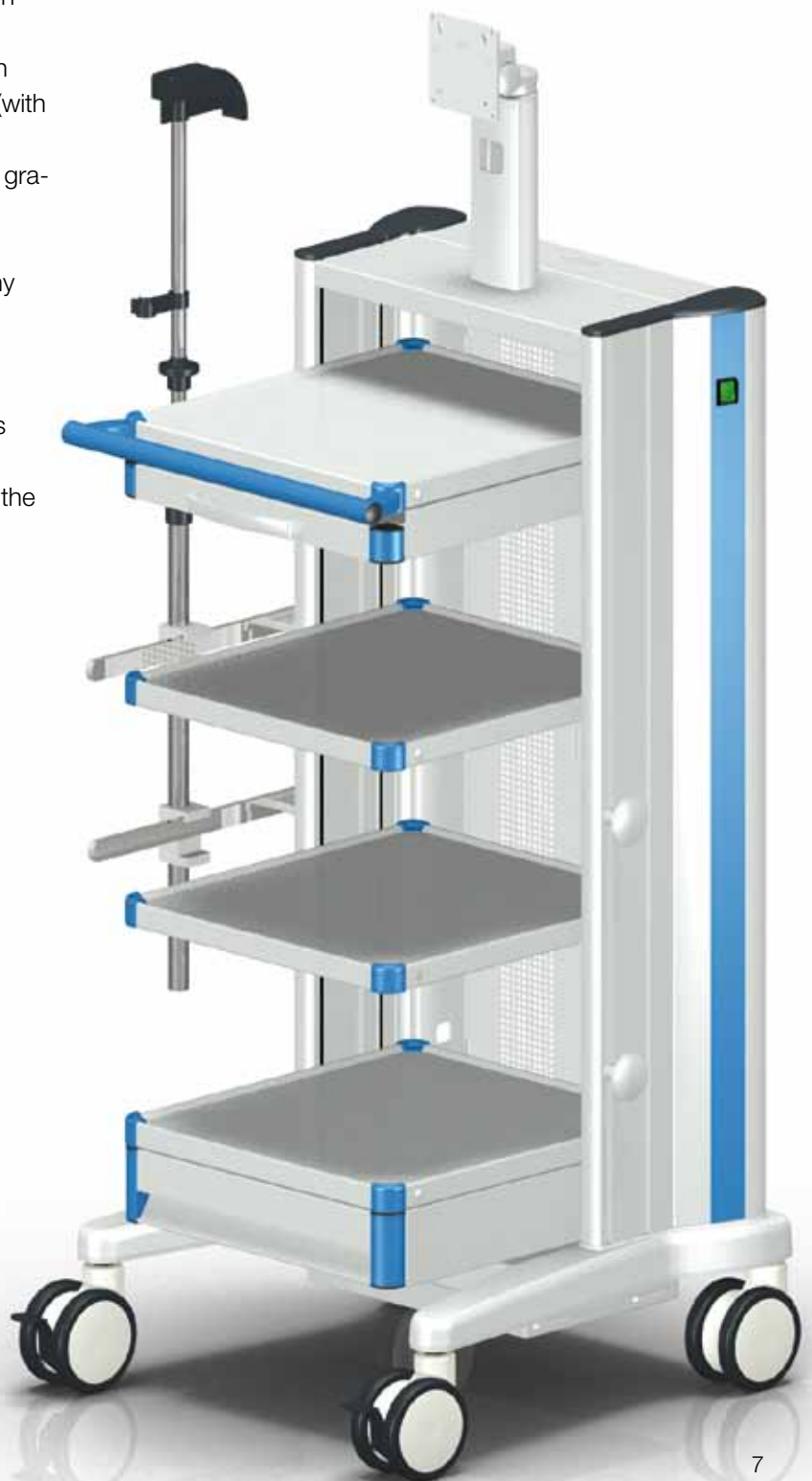
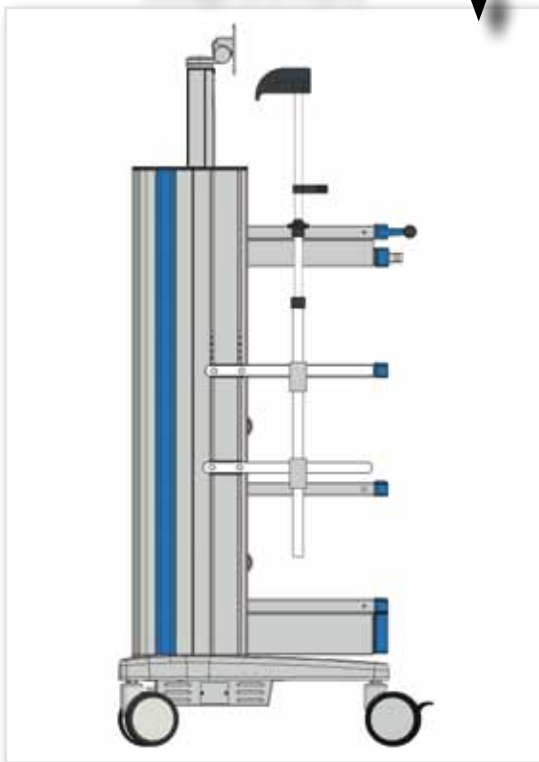

# AN OVERVIEW OF OUR TOP SUPPORTERS

Surgery, intensive care, anaesthesia or laboratory settings – each application presents different challenges to a carrier system. Excellent that ITD can offer an optimum solution for each scenario. The ITD product programme is convincing point by point through versatility and sophistication.

The following tabular presentations provide you with a quick initial overview of possible equipment carts and can assist you in making the right preliminary decisions.



**uni-cart**

with 4 stabilisers



**vexio-cart**

with 5 stabilisers

## Load capacity

Total load capacity:	65 kg / 143 lbs	50 kg / 110 lbs	65 kg / 143 lbs
Load capacity of shelf:	10 kg / 22 lbs distributed load		15 kg / 33 lbs distributed load

## Dimensions - Basic Frame

Width in mm:	540	670	530
Depth in mm:	580	650	610
Total height in mm:	820 / 1145 / 1305		830 / 998 / 1160 / 1320

## Dimensions - Shelf

Width in mm:	400	424
Depth in mm:	360	430

## Electrification

Isolating transformer:	660 VA	no
Central on / off switch:	no	no
Socket strips:	yes	yes

## Ordering data

Catalogue page:	18 - 29	38 - 51
-----------------	---------	---------





**pro-cart**



**classic-cart**



**compact-cart**

80 kg / 176 lbs

20 kg / 44 lbs distributed load

150 kg / 330 lbs

50 kg / 110 lbs distributed load

180 kg / 396 lbs

50 kg / 110 lbs distributed load

610

620

884 / 1172 / 1332

614 / 714 / 1214

625

829 / 1117 / 1437

618 / 668 / 818

624

1146 / 1306 / 1466

450

400

450 / 500 / 600

491

450 / 500 / 650

491

660 VA / 1200 VA

yes

yes

660 VA / 1000 VA / 1600 VA

yes

yes

1200 VA / 1600 VA / 2000 VA

yes

yes

60 - 71

80 - 95

104 - 117